



By Shangri-La

Traders Hotel Kuala Lumpur

National Tax Conference (NTC) 2019 5 – 6 August 2019

GROUP CODE: NAT040819

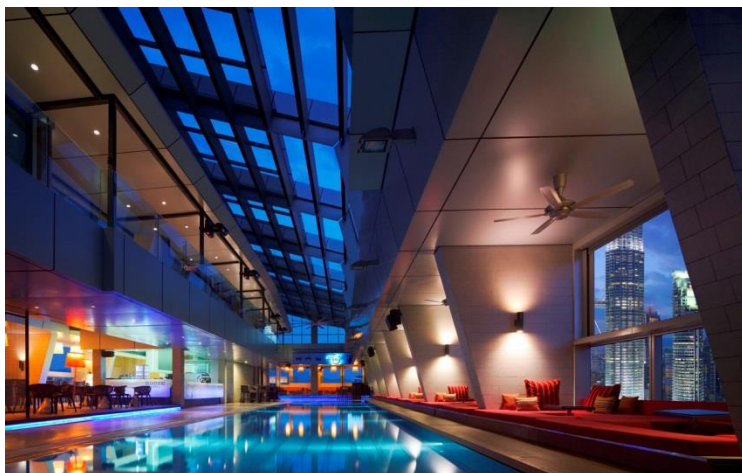

Traders Hotel, Kuala Lumpur is located in KLCC, Kuala Lumpur City Centre. Its ideal location makes it perfect for convention delegates as it is connected to Kuala Lumpur Convention Centre with five direct walkways via the Hotel's escalator or guest lifts, as well as direct access to Suria KLCC Shopping Mall and the iconic Petronas Twin Towers. The Hotel also provides a Business Centre which offers meeting rooms with natural daylight and full secretarial services.

Traders Hotel, Kuala Lumpur is 70 km from Kuala Lumpur International Airport (KLIA). It offers free shuttle (buggies) to and from Suria KLCC Shopping Mall. Royal Selangor Golf Club, Pavilion Mall and Bintang Walk shopping district are within 1.5 km from the Hotel.

All our rooms are spacious and modern in design with Petronas Twin Towers view and KLCC Park view. Each room is equipped with a LED TV, cabled broadband, built-in international adaptors, electronic safe, cable TV, iron and ironing board, hairdryer, tea and coffee making facilities. Free WiFi everywhere: available in hotel limousine, guest rooms and public areas.

Gobo Chit Chat, serves international buffet or enjoy premium steaks at Gobo Upstairs Lounge & Grill in a cosy stylish atmosphere. The rooftop open-air bar; SkyBar, offers the best view and drinks and is available for private events.



i can feel the
connection

Fill up the reservation form on the next page:

Reservations Department
Traders Hotel Kuala Lumpur

General Line: + 60 3-2332 9999 Fax: +60 3-2332 2677 Email: csteam.thkl@tradershotels.com

RESERVATION FORM



By Shangri-La

Traders Hotel Kuala Lumpur

National Tax Conference (NTC) 2019 5 – 6 August 2019

Deadline: 22 July 2019

GROUP CODE: NAT040819

GUEST DETAILS

Last Name		First Name		<input type="checkbox"/> Sharing with:	Airport Transfer From / To KLIA / KLIA2 (RM325.00Nett / car / way)		
Contact Number					<input type="checkbox"/> Pick Up <input type="checkbox"/> Drop Off <input type="checkbox"/> Roundtrip		
Email Address							
Company Name				Flight Details (24:00hrs)			
Arrival Date				Arrival Flight No		ETA	
Departure Date				Departure Flight No		ETD	

- A surcharge of 50% will be levied for transfer between 12.00am to 6.00am and the rate transfer is subject to change

ROOM CATEGORY

Room Category	Room Rates		No. of Room/s	No. of Adult/s
	Single [RM]	Double [RM]		
Deluxe Room (King/Twin)	440.00++ / 510.40nett	480.00++ / 556.80nett		
Deluxe Garden View Room (King)	480.00++ / 556.80nett	520.00++ / 603.20nett		
Deluxe Twin Towers View (King/Twin)	510.00++ / 591.60nett	550.00++ / 638.00nett		
Traders Club Room (King)	600.00++ / 696.00nett	640.00++ / 742.40nett		
Traders Club Twin Towers View Room (King/Twin)	670.00++ / 777.20nett	710.00++ / 823.60nett		
City View Suite (King)	780.00++ / 904.80nett	820.00++ / 951.20nett		
Twin Towers View Suite (King)	850.00++ / 986.00nett	890.00++ / 1,032.40nett		

- All room rates quoted are subject to 10% service charge and 6% SST. The nett room rates stating are inclusive of both taxes for reference purpose.
- Tourism Tax at RM 10.00 per room per night will be collected at the Hotel (Tourism Tax is not included in total room cost). All Malaysian Nationals and Permanent Residents holding MyPR card are exempted from the Tourism Tax.
- Room rates quoted are inclusive of Breakfast for Deluxe category
- Room rates quoted are inclusive of Traders Club Floor benefits for Traders Club & Suite room category
- Free wired and wireless broadband access [Throughout Hotel premises and in Hotel Limousine]
- Above rates are only applicable during the above conference only, 3 days prior and 3 days after the event.
- Subject to on-day availability.

PREFERENCE

<input type="checkbox"/> King Size Bed	<input type="checkbox"/> Twin Bed	<input type="checkbox"/> Non Smoking	<input type="checkbox"/> Smoking
----------------------------------------	-----------------------------------	--------------------------------------	----------------------------------

- Subject to on-day availability

ROOM GUARANTEE METHOD

<input type="checkbox"/> VISA	<input type="checkbox"/> MASTER	<input type="checkbox"/> AMEX	<input type="checkbox"/> DINERS	<input type="checkbox"/> JCB
Credit Card no	Expiry Date	Security Code	Card Holder's name	

- In order to confirm your room booking, credit card details are required upon reservation.
- The hotel will charge one room night to the above credit card which is not refundable.**

TERMS AND CONDITIONS

- Official check-in time is 1500hrs and check out time is 1200hrs.
- Full-day surcharge will be applicable for guests arriving to check in between 0001 hours to 1500 hours.
- Late check out shall be chargeable at 50% of room rate after 1200 hours but before 1600 hours. Full rate is chargeable for departures after 1600 hours onwards.
- Any cancellation or reduction of nights to hotel room bookings after **22 July 2019** will result in a late cancellation charge equivalent to full duration of stay. The hotel must be notified in writing for this.
- Full charge of the entire duration of stay will be imposed should there be any no show on day of arrival.
- Any flight changes must be advised at least 24 hours prior to arrival.
- The hotel will charge one room night to the above credit card which is not refundable. A confirmation email will follow subsequently.**